

## CANOPY

(Model # 611047)

### Assembly Instructions

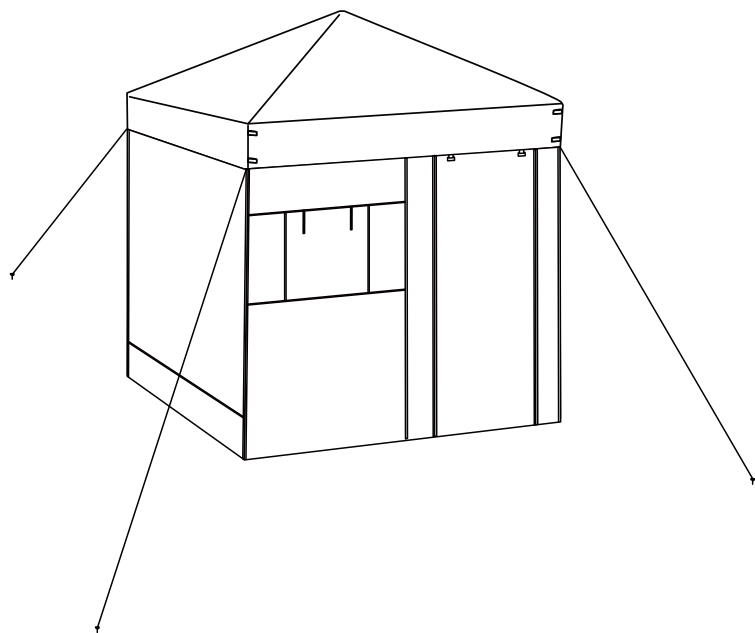

#### Dear Customers,

Thank you for purchasing our product. Please read this instruction manual carefully after receiving this product. It will help you assemble this product quickly, safely and correctly. You can keep this manual for future reference.



Please follow the instruction manuals and use a pad to protect the product during your assembly.

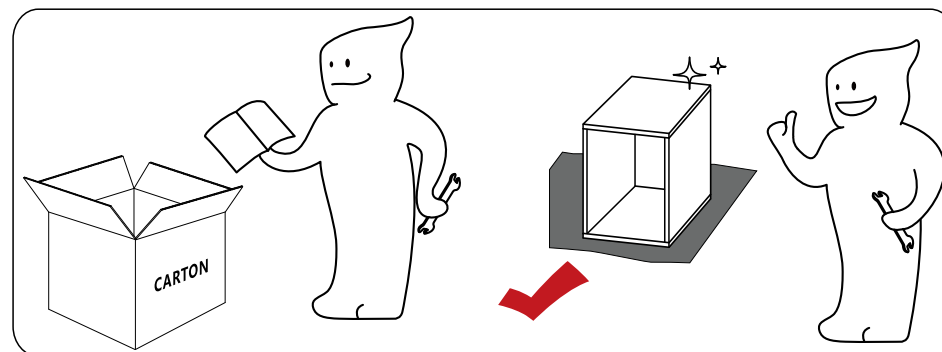
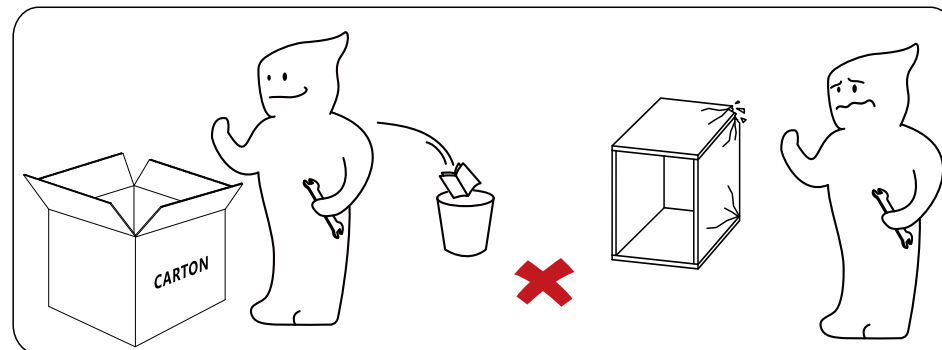

For easier and better assembly, **2** or more adults are required.



The expected assembly time for this product is **0.5 h**, depending on the individual's manipulative ability.

- This product is not intended for children to climb. Please keep your children from climbing this product.



- Do not place the product near the fire or heat sources! Caution Fire Hazard!



- Do not use corrosive cleaners for cleaning!



- Be careful of your hands when setting up! We recommend wearing protective gloves for assembly.

- Please check the number and condition of the parts according to the parts list. If any parts are damaged or missing, please contact us immediately.

- We recommend checking the tightness of all connections between parts every six months.

- The warning, cautions, and instructions listed in this manual may not cover all possible situations that may arise when using the product. Please contact us via e-mail [info@yahee.com.cn](mailto:info@yahee.com.cn) if you need further information or help.

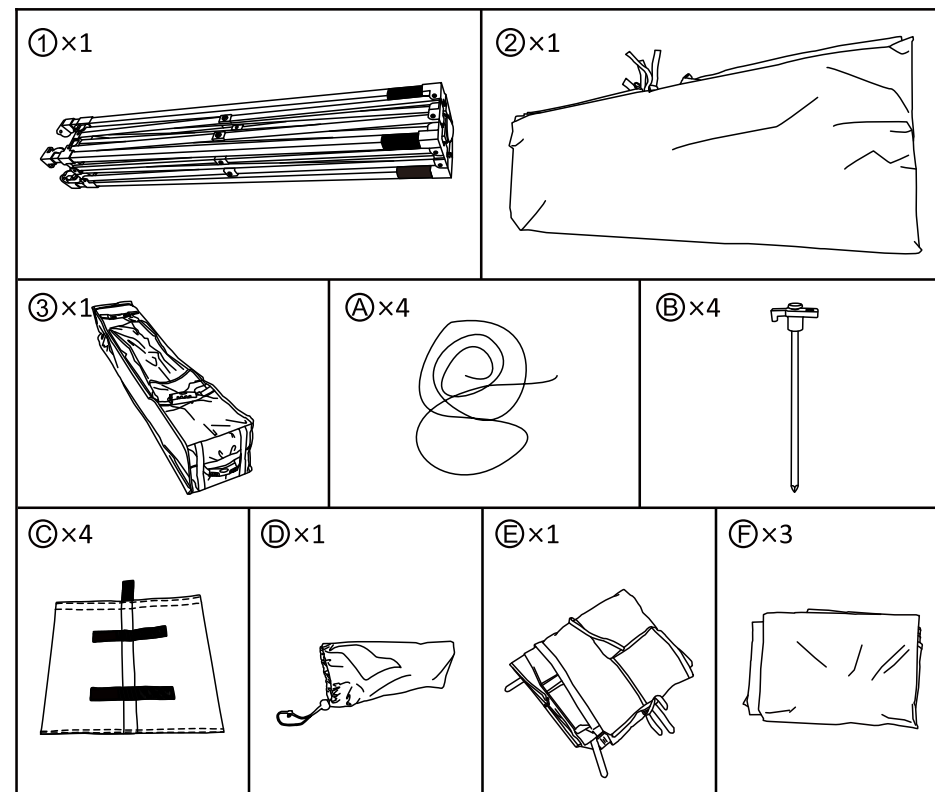

1

⚠  
Unpack and take out the canopy fabric and the frame storage bag. Other parts are packed in the frame storage bag, please take them out for further assembly.  
**Note:** Please do not use a knife when unpacking to avoid cutting the product and parts accidentally.

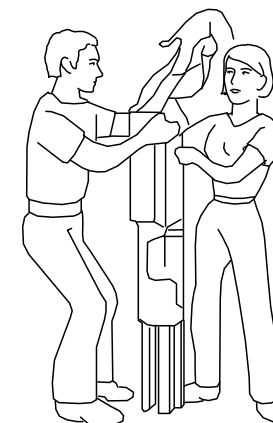
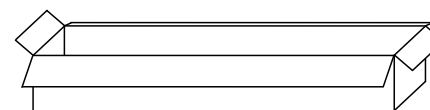

2



⚠  
Erect the frame and half-open it.

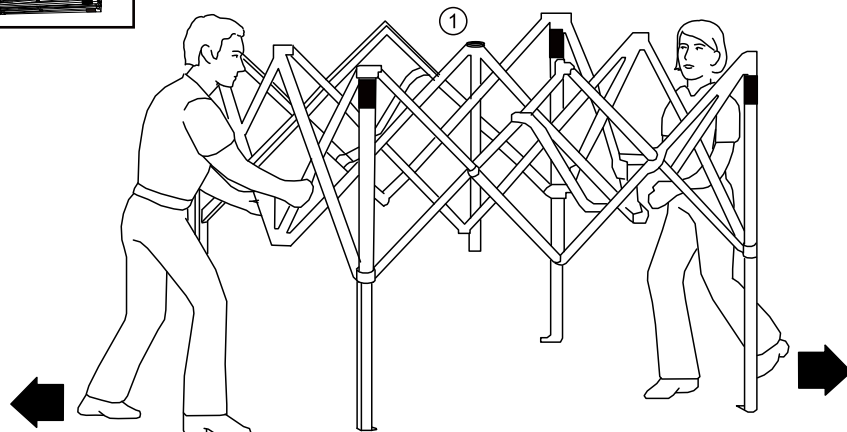

3



⚠  
Place the canopy fabric on the frame and align the four corners of the canopy fabric with the four corners of the frame.

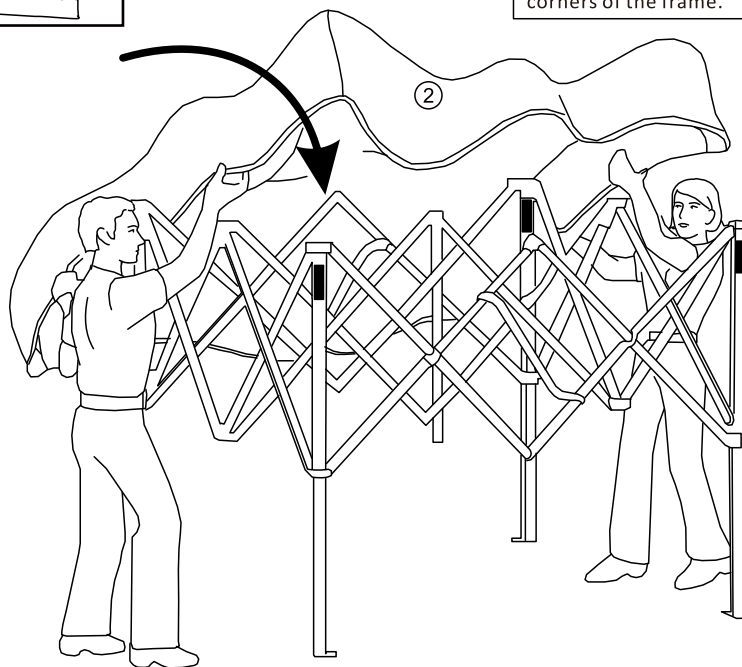

4

⚠  
Pull the drawstring on the fabric to fix the top. Attach the canopy fabric to the frame with the hoop and loop fasteners. Extend the canopy frame to the full. Pull up the horizontal bars and hear a "click" from the four frame corners, the canopy fabric is all set.

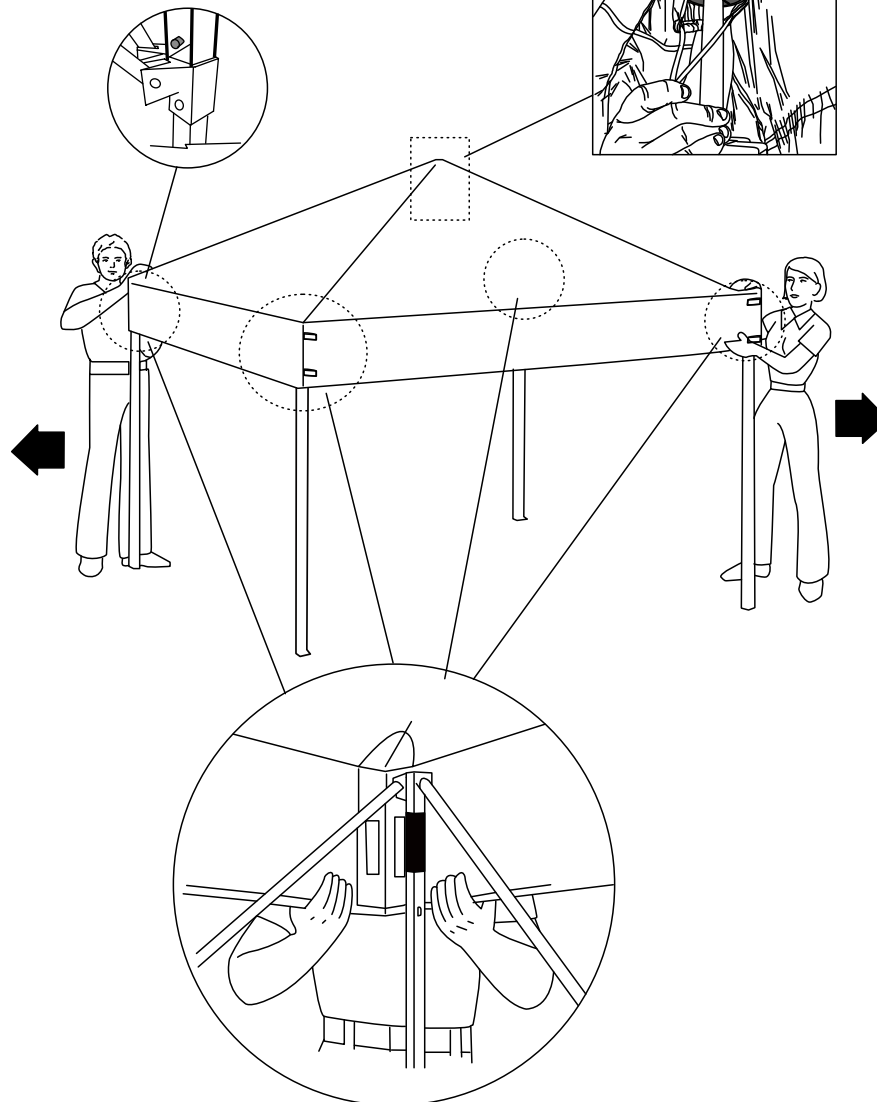

5



After setting up the canopy fabric, please reinforce the fabric to the frame with the hook and loop fasteners in the middle of each side.

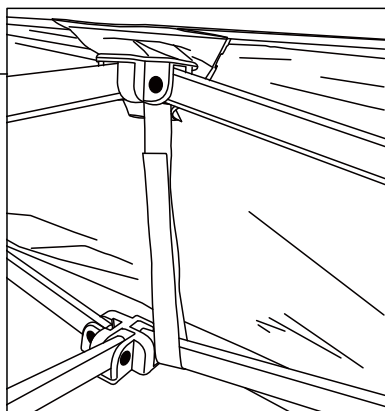
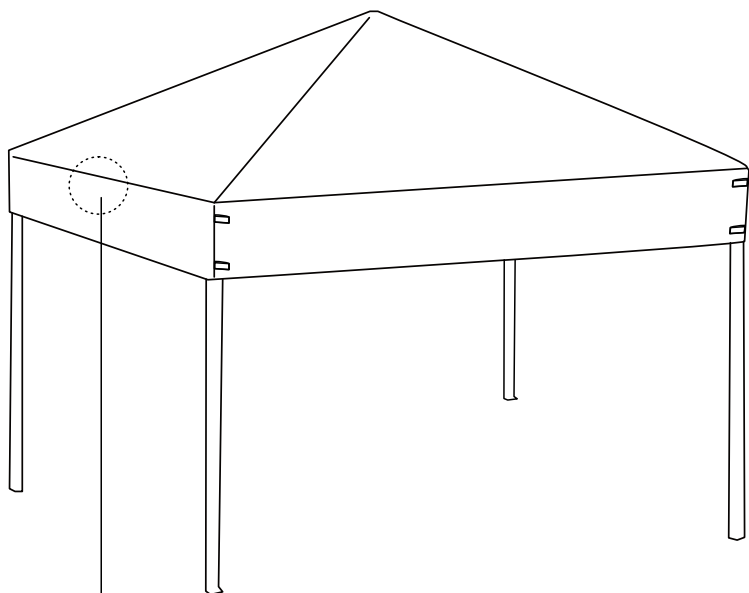

6



On the facade of the canopy, there are 4 hoops for mounting the banner(not included) if you needed.

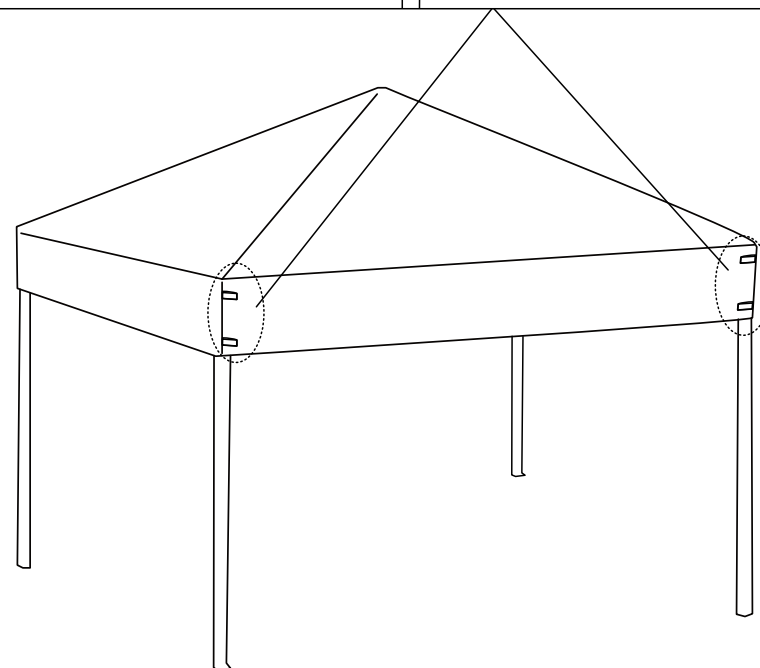

7



There is a spring button on each leg for height adjustment.

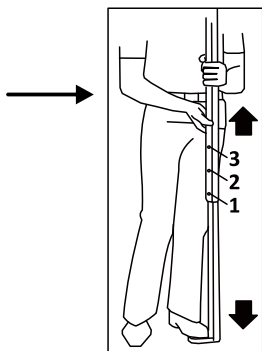
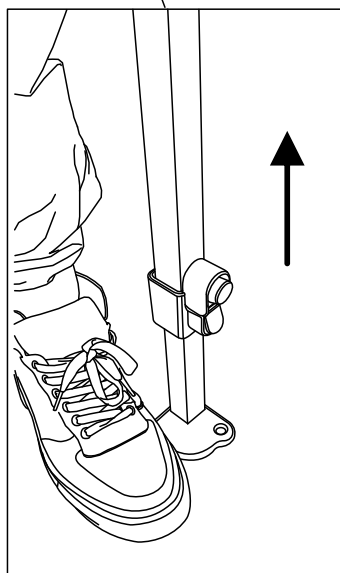
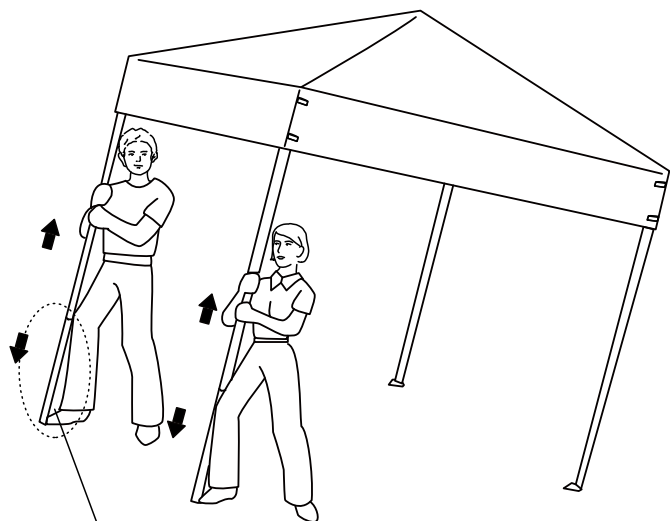

3 holes on each leg for 3 adjustable heights. Adjust the canopy height by pushing the spring buttons and sliding the telescopic outer tubes along the legs.  
**Note:** Push the spring button till the outer tube of the leg is movable, then release the button. Extend the telescopic legs to your desired height and the button will automatically lock in place. Please do not overextend the frame legs, otherwise the canopy fabric may be damaged.

8



x4



Fill up the sand bags and tie them to the frame legs.

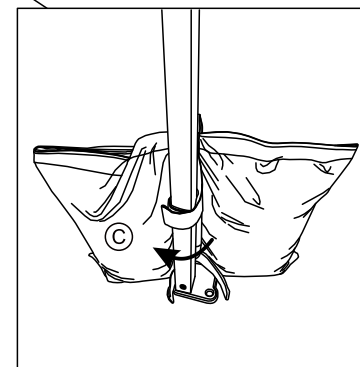
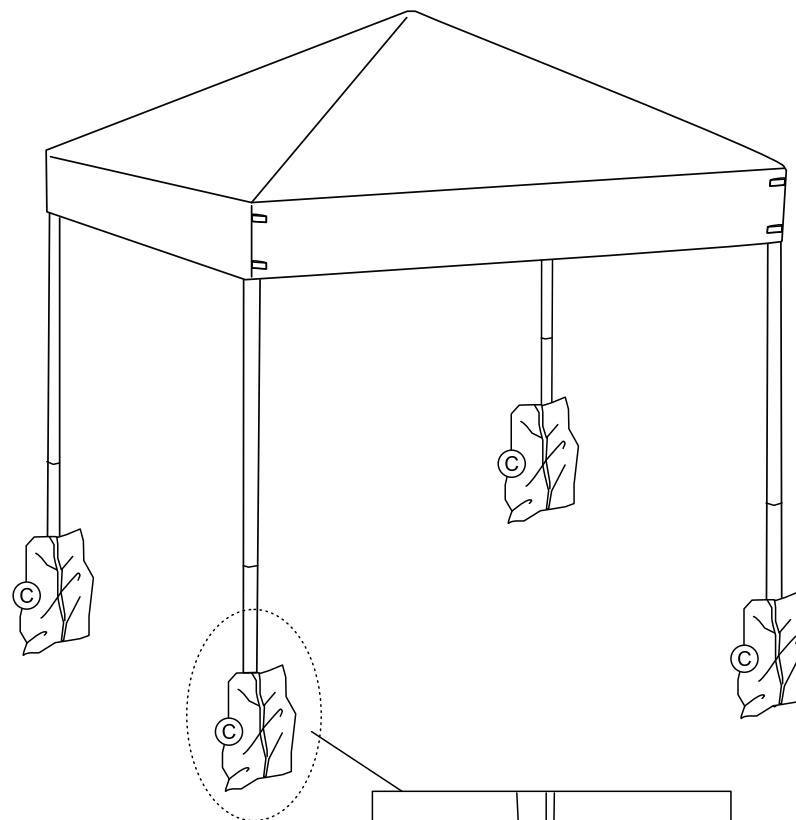

9

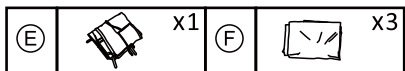

When assembling, please completely attach the hook and loop fastener of the wall as well as the door to the hook and loop fastener of the top before zipping the door and walls down.

NO.1

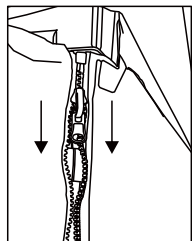

NO.2

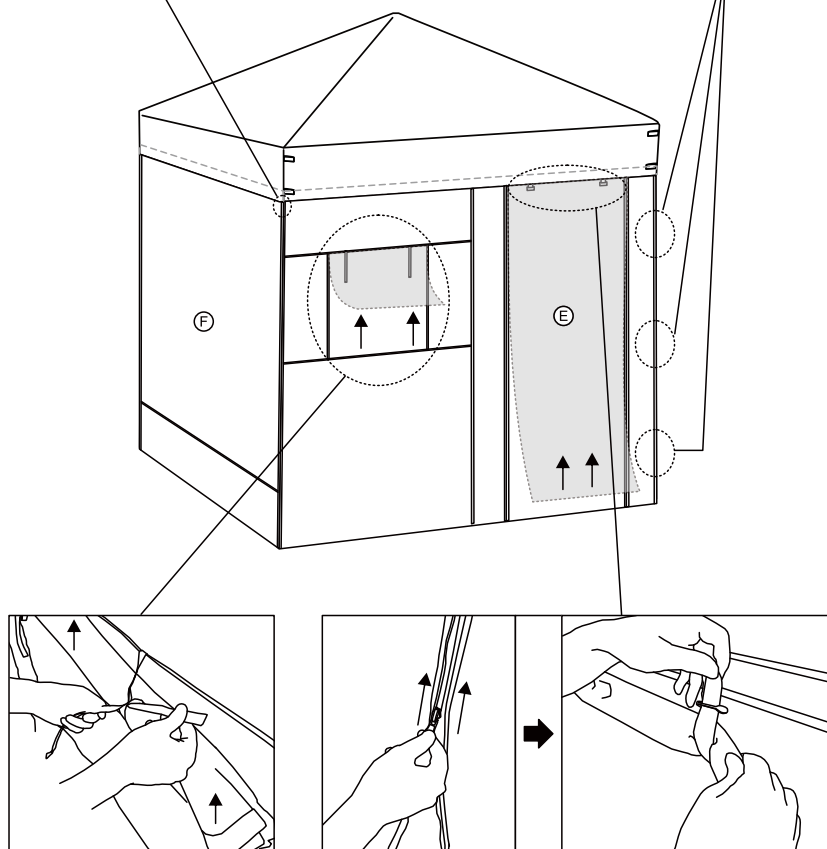
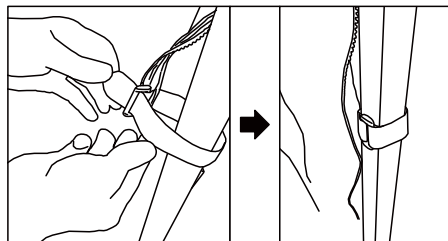

10

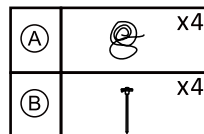

Connect the canopy fabric and the ground anchors with ropes, and fix the anchors into the ground for added stability.

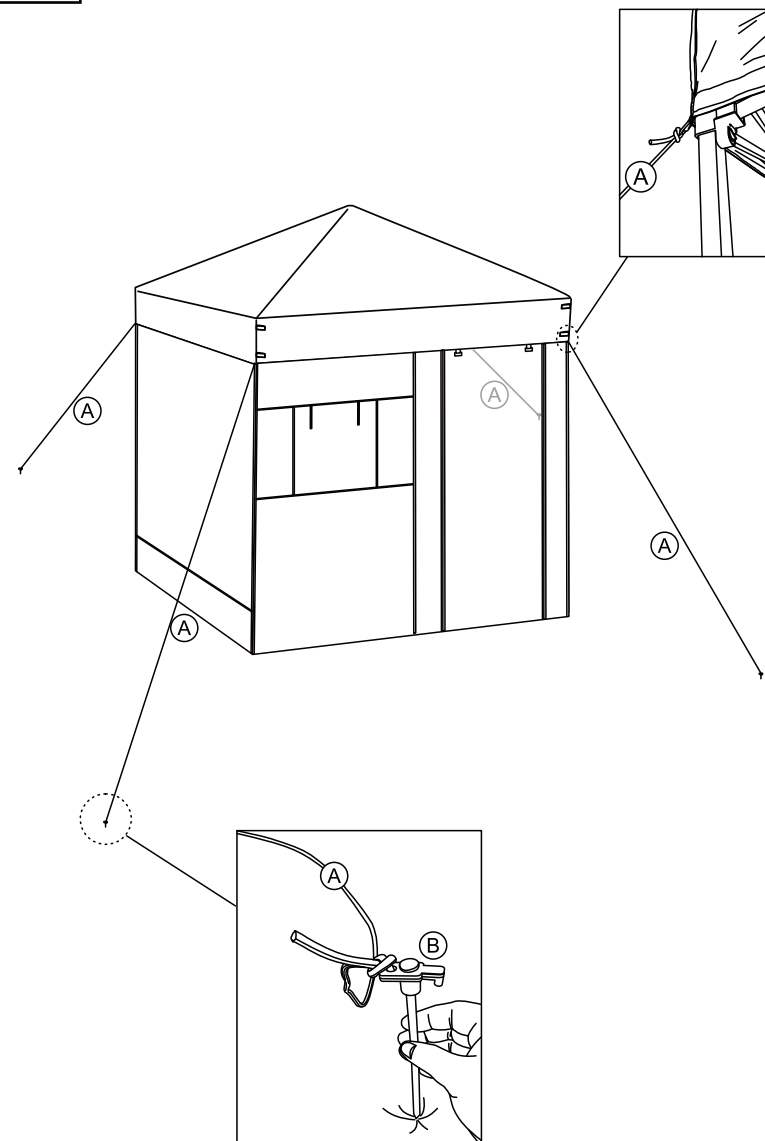

**Thank you for purchasing a Yaheetech product!**

At Yaheetech, we are dedicated to bringing you the best online shopping experience and making your life comfortable. We pride ourselves on an integrated supply chain team that works meticulously to deliver you products and service with greatest value. Our networks span across the US, the United Kingdom, Germany, France and six more European countries. It is always our belief that how customers view our business and service ultimately defines our brand.

So, how did we do? Please let us know by making an online remark about it.

😊 **Good job.** Would you like to share your experience to assist others with their shopping decisions?

😞 **Not good.** Can you give us a chance to fix the problem?

You can also get a downloadable user manual by scanning the QR code below.



611047

[www.yaheeshop.com/  
pdf/en-1-6011269.pdf](http://www.yaheeshop.com/pdf/en-1-6011269.pdf)